

# Remote Control User Manual

## MMC4401

### Product Description

This remote control can be used to control RF433 devices with encoding 1527. Before using it, you need to simply pair the remote with the buttons on your curtain switch. Correspond the three buttons on the remote control (open, pause, close) to the corresponding functions of the required device. No other codes available for this curtain control system, highly recommend to use this special remote for controlling our MoesGo curtain switch or switch module. Do not use this remote to control other irrelevant devices.

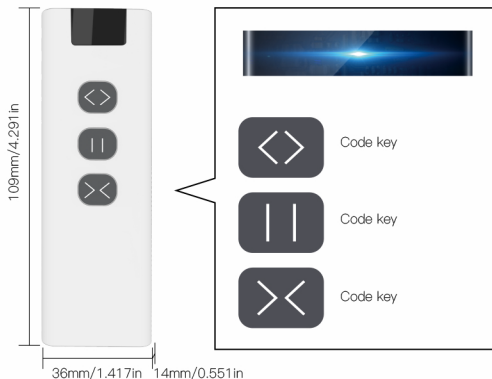

### Product parameter

Working voltage:	12V
Working frequency:	433MHz
Encoding mode:	Imitation learning code
Working current:	≤18mA